

SWAGE SLEEVE

ZINC PLATED COPPER



Made in
USA



Precision
Machined

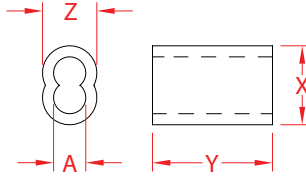
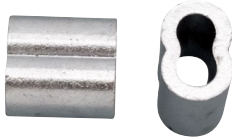

ITEM	A (wire / wire mm)	CRIMPS	HOLE #	X (height)	Y (length)	Z (width)	WT (lb)	PACKAGING TYPE	EACH (qty)	INNER (qty)	CARTON (qty)	UPC
Z0753-0001	1/16" - 1.5 mm	2	1	0.25"	0.37"	0.17"	0.01/100	POLYBAG	1	100	1,000	791506058960
Z0753-0002	3/32" - 2.5 mm	3	2	0.37"	0.40"	0.22"	0.6/100	POLYBAG	1	10	1,000	791506058977
Z0753-0003	1/8" - 3.0 mm	3	3	0.49"	0.55"	0.33"	0.01	POLYBAG	1	100	500	791506058984
Z0753-0004	5/32" - 4.0 mm	3	4	0.59"	0.61"	0.37"	0.02	POLYBAG	1	10	500	791506058991
Z0753-0005	3/16" - 5.0 mm	3	5	0.67"	0.94"	0.45"	0.05	POLYBAG	1	10	500	791506059004
Z0753-0006	7/32" - 5.5 mm	3	N/A	0.72"	0.86"	0.46"	0.04	POLYBAG	1	10	300	791506059011
Z0753-0007	1/4" - 6.0 mm	3	1	0.81"	1.11"	0.52"	0.07	POLYBAG	1	10	300	791506059028
Z0753-0009	5/16" - 8.0 mm	3	HYDRAULIC	1.02"	1.05"	0.67"	0.12	POLYBAG	1	10	350	791506059035
Z0753-0010	3/8" - 9 mm	3	HYDRAULIC	1.11"	1.24"	0.73"	0.15	POLYBAG	1	5	200	791506059042
Z0753-0013	1/2" - 12 mm	3	HYDRAULIC	1.47"	1.89"	0.96"	0.38	POLYBAG	1	1	75	791506059059

NOTE:

FOR 1/16" - 1/8", USE E0113-0350. FOR 1/16" - 3/16", USE E0113-0600. FOR 1/4" USE E0113-0700. USE A HYDRAULIC SWAGER ON LARGER SIZES. ALL DIMENSIONS ARE NOMINAL (+/- 3%) AND ARE SUBJECT TO CHANGE WITHOUT NOTICE.